

FENCE NOTES

- ALL POSTS & RAILS SHALL BE SCHEDULE 40, HOT-DIPPED GALVANIZED ZINC WITH FUSION BONDED COATING ON OUTSIDE SURFACE (ASTM 668 TYPE 2B). COLOR: WOODLAND GREEN OR BLACK (OR AS SPECIFIED).
- FABRIC IS TO BE NO. 9 ASW GA. STEEL CORE CHAIN LINK 2" DIAMOND MESH, FUSION-BONDED (ASTM 668 TYPE 2B). COLOR: TO MATCH FABRIC (OR AS SPECIFIED).
- ALL FABRIC SHALL BE SECURED TO POSTS & RAILS AT 18" MAX. SPACING.
- ALL ASSORTED HARDWARE SHALL BE FUSION BONDED (ASTM 668 TYPE 2B).
- ALL FOOTINGS SHALL BE 12" DIAMETER, MSHA NO. 2 CONCRETE.
- PIPE WEIGHTS: 1 1/8" O.D. = 2.27 LBS./LIN. FT.
2 1/4" O.D. = 3.65 " " "
3" O.D. = 5.79 " " "

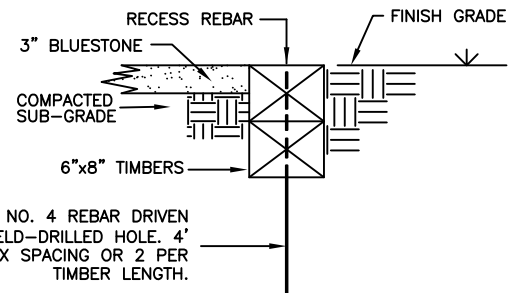

THE MARYLAND-NATIONAL CAPITAL PARK AND PLANNING COMMISSION
Department of Park and Planning, Montgomery County, Maryland

PARK
DEVELOPMENT
DIVISION
9500 BRUNETT AVENUE
SILVER SPRING, MD 20901

DATE APPROVED _____
CHIEF ENGINEER _____
SUPERINTENDENT OF PARKS _____

PLAYERS' BENCH AREA
WITH FENCING

REVISED	DATE	STANDARD NO.
		104